

The Mediterranean Border

A warm lavender, hot pink and purple planting scheme in this striking continental, Mediterranean garden.

Use the Planting Plan to position your plants, and the table on the right to cross-refer to the separate Planting List on our website.

CLICK HERE to buy plants online for home delivery...

AG Code	Plant Common Name	Quantity
pc005	Strawberry Grape Vine	1
ps009	Tree Peony	1
ps011	Smoke Bush	1
ps012	Wormwood	4
pp017	Paeony	5
pp018	Japanese Anemone	5
pp019	Bloody Cranesbill	7
pp020	Ice Plant	8
pp021	Oriental Poppy	4
pg004	Blue Oat Grass	6

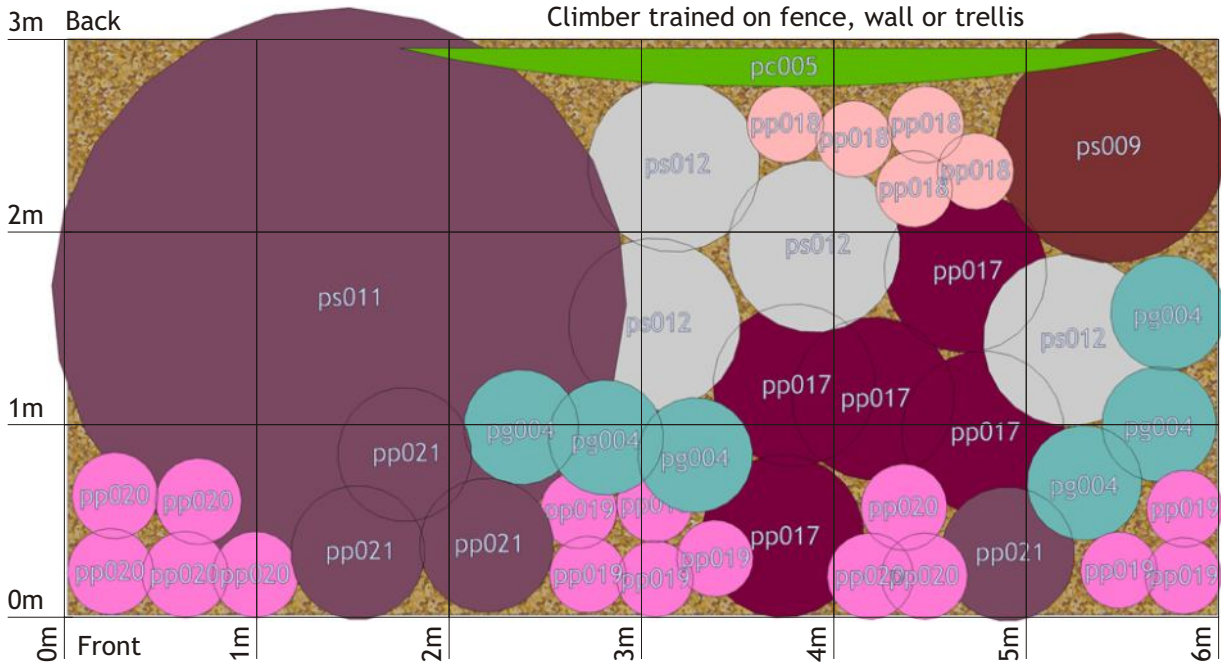

your Planting Design

This border has been planned around future growth and spread. To use this design for smaller areas, starting from the bottom left-hand corner, draw your actual area onto the plan, and omit any plants outside this new size.

STYLE Mediterranean Planting Design		SIZE 6m x 3m	Plot to Scale
SOIL TYPE Loam	SUNLIGHT Full Sun	REF. FD_smed_su63lo_1	

- ! Use the blanks in the table for any plant substitutions you make.
- ! Use the width & depth scale bars and grid to assist in positioning the plants.
- ! See the separate Planting List for more details on each of your plants.