

The Country Border

A riot of pink, white, blue & purple planting look great in this traditional, country garden.

Use the Planting Plan to position your plants, and the table on the right to cross-refer to the separate Planting List on our website.

CLICK HERE to buy plants online for home delivery...

AG Code	Plant Common Name	Quantity
pc020	Silk-tassel Bush	1
ps024	American Redbud	3
ps025	Rugosa Rose	1
pp032	Bloody Cranesbill	14
pp041	Catmint	10
pp045	Coneflower	7
pp046	Globe Thistle	8
pp047	Gaura	13
pp048	Daylily	8

3m Back

Climber trained on fence, wall or trellis

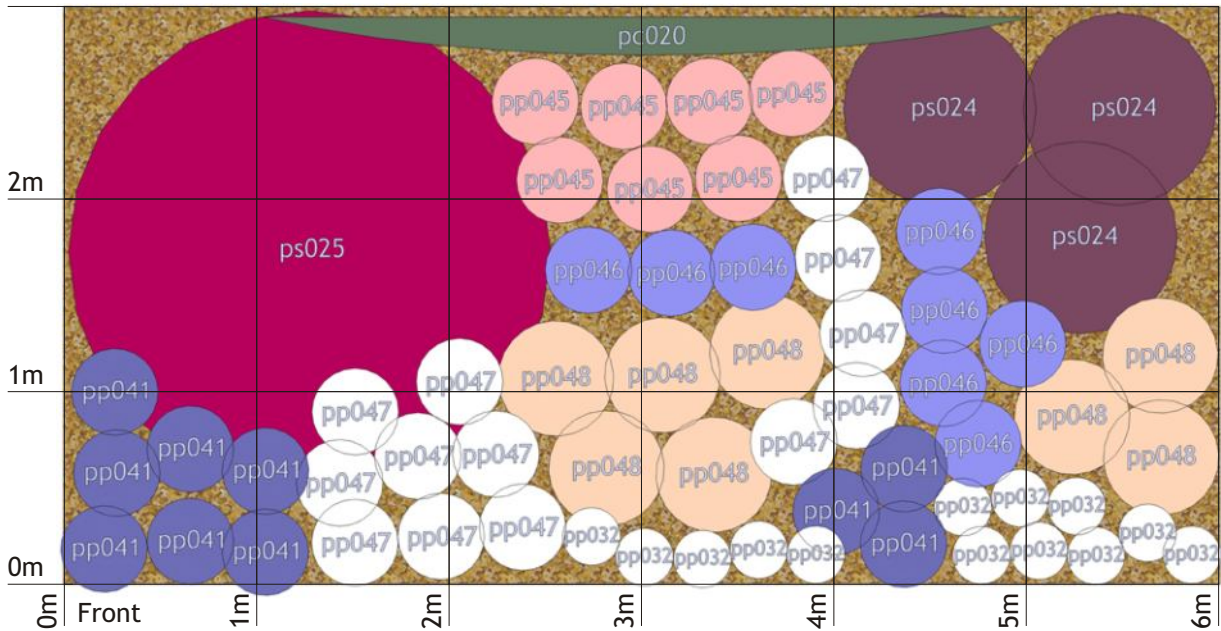

your Planting Design

This border has been planned around future growth and spread. To use this design for smaller areas, starting from the bottom left-hand corner, draw your actual area onto the plan, and omit any plants outside this new size.

STYLE Country Planting Design		SIZE 6m x 3m Not to Scale
SOIL TYPE Loam	SUNLIGHT Full Sun	REF. RD_scou_su63lo_1

- ! Use the blanks in the table for any plant substitutions you make.
- ! Use the width & depth scale bars and grid to assist in positioning the plants.
- ! See the separate Planting List for more details on each of your plants.